

YOUR **BEST SOURCE** FOR
METRIC MOTORS, GEARBOXES & COOLANT PUMPS

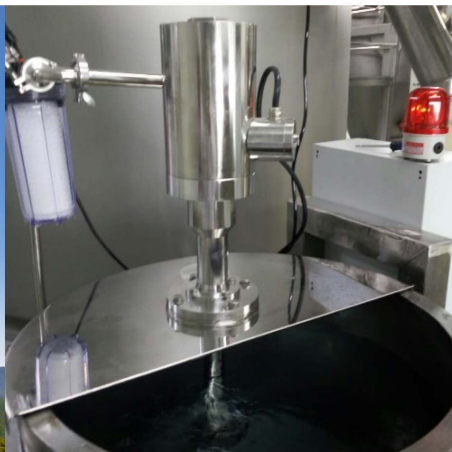

LA - IP56 Stainless Steel Motors

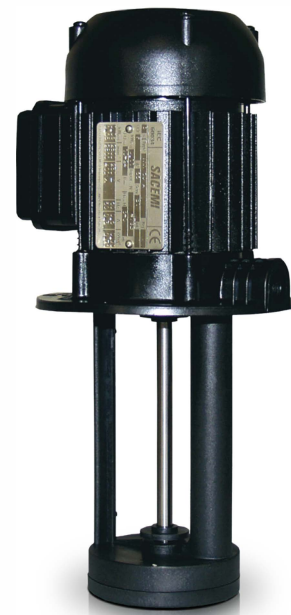
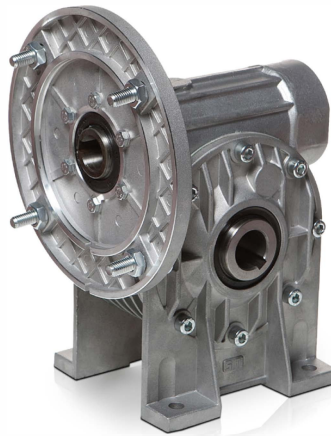
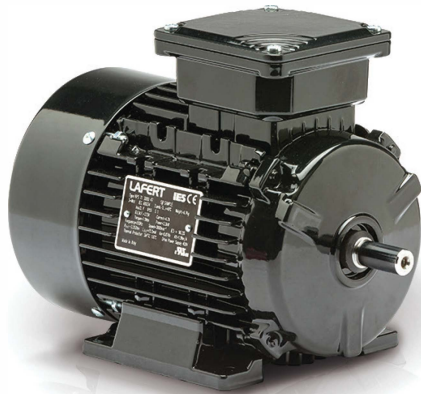

“Wash-down Protection”

1.15 Service Factor (SF) • Available in IEC 63 to 80 frame sizes in 2, 4 and 6 poles • 230/460V or 333/575V 60 Hz
 All stainless Steel Construction • IP56 wash down • Class F insulation • Drain holes at 90° positions • Etched nameplate
 Available in B3, B14 and B5 mounting • TENV • CSA safety approvals • Turn Down Ratio 4:1 CT 10:1 VT



See page 5 for connection diagrams

2 POLE - 3600 RPM

Part Number	Enclosure	HP	Full Load Amps		Speed Min ⁻¹	Weight (lbs)	List Price \$
			460 V	575 V			
LA63S2	TENV	0.33	0.53	0.43	3455	18	740.00
LA71C2	TENV	0.50	0.75	0.60	3515	26	842.00
LA71S2	TENV	0.75	1.05	0.84	3500	31	878.00

4 POLE - 1800 RPM

Part Number	Enclosure	HP	Full Load Amps		Speed Min ⁻¹	Weight (lbs)	List Price \$
			460 V	575 V			
LA63S4	TENV	0.25	0.53	0.43	1740	18	732.00
LA71C4	TENV	0.33	0.58	0.47	1750	19	846.00
LA71S4	TENV	0.50	0.75	0.60	1745	24	880.00
LA80C4	TENV	0.75	1.10	0.88	1765	39	1,061.00

6 POLE - 1200 RPM

Part Number	Enclosure	HP	Full Load Amps		Speed Min ⁻¹	Weight (lbs)	List Price \$
			460 V	575 V			
LA71C6	TENV	0.25	0.66	0.53	1145	23	989.00
LA71S6	TENV	0.33	0.78	0.62	1145	25	1,030.00
LA80C6	TENV	0.50	0.88	0.70	1150	40	1,218.00
LA80S6	TENV	0.75	1.20	0.95	1150	45	1,377.00

FLS B5 Flanges

Part Number	List Price \$
FLS 63B5	127.00
FLS 71B5	218.00
FLS 80B5	232.00

FLS B14 Flanges

Part Number	List Price \$
FLS 63B14	123.00
FLS 71B14	204.00
FLS 80B14	230.00

NOTE: Lowest drain plug must be removed to allow proper drainage

IM B3 & IM B34 - C Flange

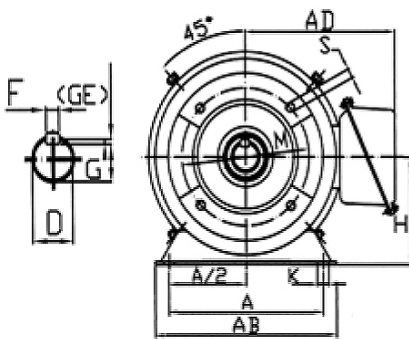

IM B5 - D Flange

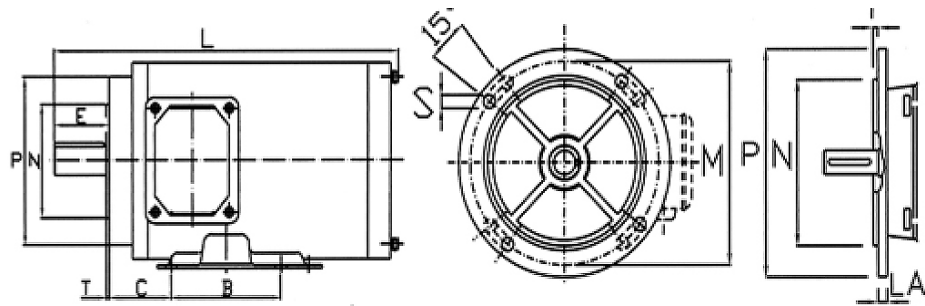

(Totally Enclosed Non-Ventilated)

Perfect for the food processing and pharmaceutical industries • 300 series stainless steel construction on all exterior parts • Double gaskets in conduit box • Paint free housing • Laser etched nameplate on frame body • Wash down protected • Sanitary • Durable • All IEC Frames

All dimensions in mm

Motor Type														B14 FLANGE					B5 FLANGE					
	A	A/2	B	C	D	E	F	G	H	K	AB	AC	AD	L	M	N	P	S	T	M	N	P	S	T
LA 63	100	55.0	80	40	11	23	4	8.5	63	7	125	114	112	241	75	60	90	M5	2.5	115	95	140	10	3.0
LA 71	112	56.0	90	45	14	30	5	11.0	71	7	140	134	122	278	85	70	105	M6	2.5	130	110	160	10	3.5
LA 80	125	62.5	100	50	19	40	6	15.5	80	10	150	144	127	322	100	80	120	M6	3.0	165	130	200	12	3.5

of holes = 4

1.15 Service Factor (SF) • Available in IE1 (0.25HP to 0.75HP) & IE3 (1HP & larger) in 2 and 4 poles • IP67 or IP69K
230/460V or 333/575V 60 Hz • All stainless Steel 304 Construction (Shafts made of SS420 steel grade)
Class F insulation • Etched nameplate • Available in B3, B14 and B5 mounting • Includes Thermistors (150°C)
Round lead box equipped with stainless steel cable glands & 1 meter of 4 core double insulated cable
Turn down ratio 3:1CT & 10:1 VT • CSA safety approvals • IE3 CSA energy verified • TENV or TEFC design



See page 5 for connection diagrams

20% adder to list price for IP69K motors

2 POLE - 3600 RPM

Part Number	Enclosure	HP	Full Load Amps			Speed Min ⁻¹	Weight (lbs)	List Price \$
			460 V	575 V				
LA 63 1-2	TENV	0.25	0.35	0.30	3430	23	943.00	
LA 63 2-2	TENV	0.35	0.48	0.38	3420	25	983.00	
LA 71 1-2	TENV	0.50	0.69	0.56	3450	31	1,138.00	
LA 71 2-2	TENV	0.75	1.00	0.88	3430	35	1,188.00	
LA 80 1-2 *	TENV	1.00	1.36	1.09	3450	45	1,704.00	
LA 80 2-2 *	TENV	1.50	1.95	1.60	3470	51	1,755.00	
LA 90S 1-2 *	TEFC	2.00	2.40	2.06	3475	66	2,482.00	
LA 90L 1-2 *	TEFC	3.00	3.50	2.98	3475	70	2,488.00	
LA 100L 1-2 *	TEFC	4.00	4.60	3.63	3485	86	3,086.00	
LA 112M 1-2 *	TEFC	5.50	6.00	5.20	3460	106	5,628.00	
LA 132S 1-2 *	TEFC	7.50	8.10	6.44	3540	187	7,125.00	
LA 132S 2-2 *	TEFC	10.00	10.90	8.72	3540	198	7,223.00	
LA 132M 1-2 *	TEFC	15.00	15.90	12.72	3535	220	9,896.00	

4 POLE - 1800 RPM

Part Number	Enclosure	HP	Full Load Amps			Speed Min ⁻¹	Weight (lbs)	List Price \$
			460 V	575 V				
LA 63 2-4	TENV	0.25	0.48	0.38	1700	25	1,004.00	
LA 71 1-4	TENV	0.35	0.58	0.45	1740	30	1,123.00	
LA 71 2-4	TENV	0.50	0.83	0.65	1740	33	1,188.00	
LA 80 1-4	TENV	0.75	1.24	0.96	1730	45	1,433.00	
LA 80 2-4 *	TENV	1.00	1.62	1.26	1730	49	1,744.00	
LA 90S 1-4 *	TEFC	1.50	1.90	1.59	1755	66	2,404.00	
LA 90L 1-4 *	TEFC	2.00	2.60	2.10	1750	69	2,461.00	
LA 100L 1-4 *	TEFC	3.00	3.70	3.47	1750	84	3,333.00	
LA 100L 2-4 *	TEFC	4.00	5.10	4.63	1750	84	3,379.00	
LA 112M 1-4 *	TEFC	5.50	6.00	5.73	1755	104	5,662.00	
LA 132S 1-4 *	TEFC	7.50	9.00	7.90	1760	178	7,135.00	
LA 132M 1-4 *	TEFC	10.00	12.10	10.20	1760	207	7,819.00	
LA 132M 2-4 *	TEFC	15.00	16.90	14.50	1765	338	8,601.00	

* Premium Efficiency

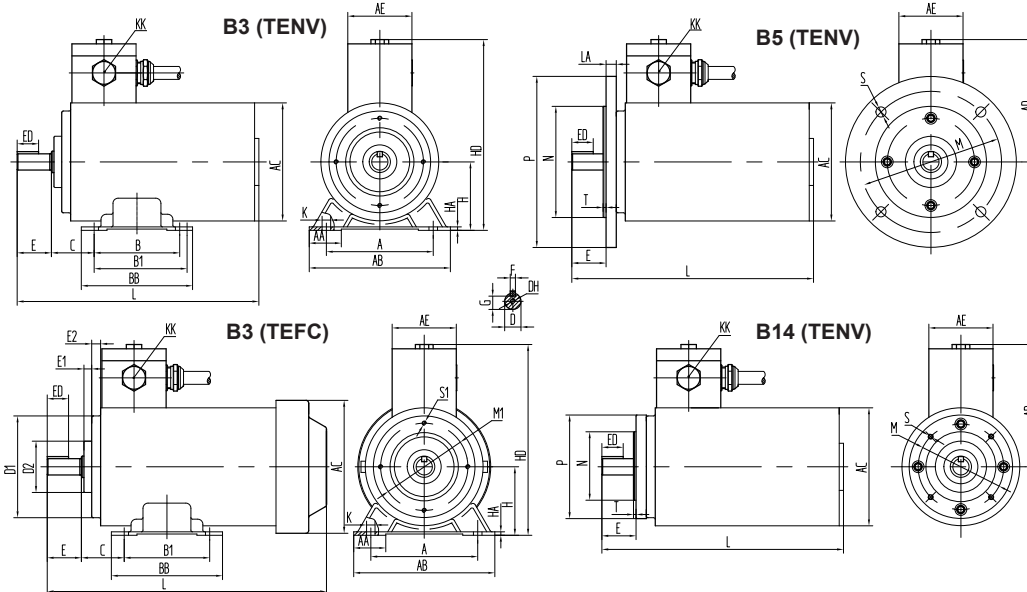

Modular Flanges

See page 4 for flange list

Frame (H)	A	AA	AB	BB	HA	B	B1	C	D	D1	D2	DH	E	E1	E2	F	G	HD	K	KK METRIC	AE	LA	ED	L TENV	L TEFC
63	100	32	132	110	4	80	N/A	40	11	95	45	M3	23	11.5	20.0	4	8.5	190	7	2-M20x1.5	65	15	13	265	300
71	112	30	140	120	4	90	N/A	45	14	108	50	M4	30	10.0	26.5	5	11.0	205	7	2-M20x1.5	65	15	20	290	335
80	125	37.5	165	130	4	100	N/A	50	19	119	60	M6	40	6.5	10.5	6	15.5	230	10	2-M20x1.5	75	12	25	323	360
90	140	40	180	165	4	100	125	56	24	135	80	M6	50	7.5	15.0	8	20.0	255	10	2-M20x1.5	75	12	40	375	415
100	160	45	205	180	4	140	N/A	63	28	150	76	M10	60	7.5	7.0	8	24.0	280	12	2-M20x1.5	85	12	45	430	480
112	190	60	250	180	5	140	N/A	70	28	166	76	M10	60	7.0	28.0	8	24.0	315	13	2-M25x1.5	85	12	45	440	495
132	216	60	276	218	5	140	178	89	38	200	93	M12	80	11.5	24.0	10	33.0	350	13	2-M25x1.5	85	16	63	555	617

Frame (H)	AD	AC TENV	AC TEFC	M1	S1	M	N	B5 P	S	T	M	N	B14 P	S	T
63	128	119	133	78	M6	115	95	140	10	3.5	75	60	95	M5	2.5
71	135	129	150	90	M6	130	110	160	10	3.5	85	70	105	M6	2.5
80	150	139	165	102	M6	165	130	200	12	3.5	100	80	120	M6	3.0
90	160	164	190	115	M6	165	130	200	12	3.5	115	95	140	M8	3.0
100	185	186	210	96	M6	215	180	250	15	4.0	130	110	160	M8	3.5
112	203	220	240	96	M6	215	180	250	15	4.0	130	110	160	M8	3.5
132	215	261	280	153	M8	265	230	300	15	4.0	165	130	200	M10	4.0

Aluminum Flanges

ST, AM,FB, AAF, AMBZ, MS, LM(E), DVE, AMPH Motors

B5 'D' Flange	B14 'C' Flange
FL56B5	FL56B14
FL63B5	FL63B14
FL71B5	FL71B14
FL80B5	FL80B14
FL90B5	FL90B14
FL100B5 *	FL100B14 *
FL112B5	FL112B14
FL132B5	FL132B14
FL160B5	FL160B14

*AMPH 100 frame motors in 4 & 6 pole require H4 flanges

Stainless Steel Flange Adapter Plates

LA Motors (IP67 & IP69K)

B5 'D' Flange	B14 'C' Flange
FLP63B5	FLP63B14
FLP71B5	FLP71B14
FLP80B5	FLP80B14
FLP90B5	FLP90B14
FLP100B5	FLP100B14
FLP112B5	FLP112B14
FLP132B5	FLP132B14

Cast Iron Flanges

LAB Motors

B5 'D' Flange
FLD132B5
FLD160B5
FLD180B5
FLD200B5
FLD225B5
FLD250B5
FLD280B5
FLD315B5

Explosion Proof Flanges

MAK Motors

B5 'D' Flange	B14 'C' Flange
FLEX56B5	FLEX56B14
FLEX63B5	FLEX63B14
FLEX71B5	FLEX71B14
FLEX80B5	FLEX80B14
FLEX90B5	FLEX90B14
FLEX100B5	FLEX100B14
FLEX112B5	FLEX112B14
FLEX132B5	FLEX132B14
FLEX160B5	FLEX160B14
FLEX180B5	Machined for shaft oil seals NEMA flanges available
FLEX200B5	
FLEX225B5	
FLEX250B5	
FLEX250B5	

Increased and Reduced Aluminum Flanges

ST, AM, FB, AAF, AMBZ, MS, LM(E), DVE, AMPH Motors

B5 Reduced	B5 Increased	B14 Reduced	B14 Increased
FL63B5R56	FL63B5I71	FL63B14R56	FL56B14I63
FL71B5R56*	FL71B5I80	FL71B14R63	FL63B14I71
FL71B5R63		FL80B14R63	FL63B14I80
FL80B5R63		FL80B14R71	FL71B14I80
FL80B5R71		FL90B14R71	FL71B14I90
FL90B5R71 *		FL90B14R80	FL80B14I90
FL100B5R71 *		FL100B14R90	FL80B14I100
FL100B5R80		FL132B14R100	FL90B14I100
FL100B5R90		FL132B14R112	FL100B14I132
FL112B5R90 */ **		FL160B14R132	FL112B14I132
FL132B5R112 *			
FL160B5R132 ***			

* May require windings pressed at additional cost

** Shaft machining required at additional cost

*** If frame is 160L: shaft extension is required.

If frame is 160M: shaft extension and bearing repositioning is required

NOTE: B5 increased and reducing flanges may require the motor to be customized to accept the flange. An additional charge may be applicable.

Wiring Diagrams

6-LEAD MOTOR CONNECTION Δ / Y

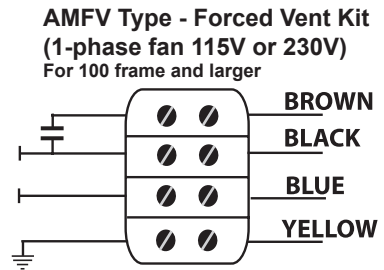
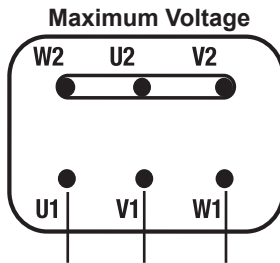
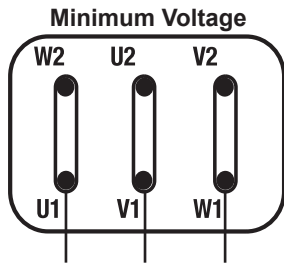

9-LEAD MOTOR CONNECTION YY / Y

6 Post Block (80 - 112 frame)

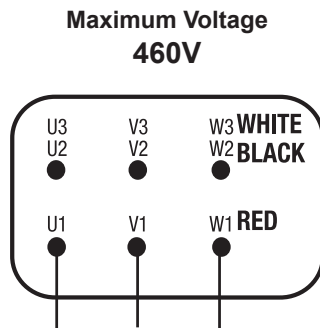
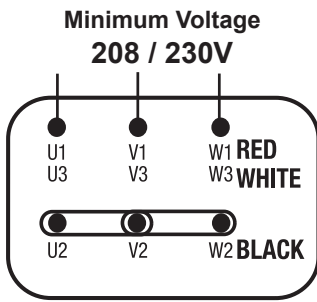

9 Post Block (132 - 160 frame)

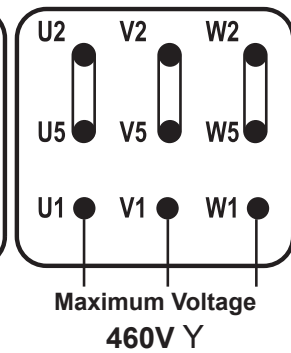
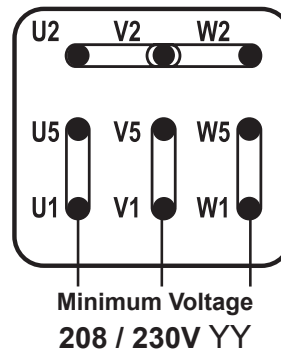

2 SPEED (1 WINDING) {2/4 & 4/8 POLES}
Low Speed High Speed

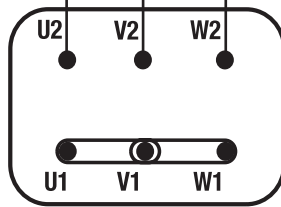
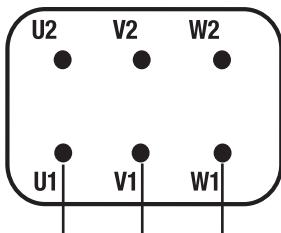

2 SPEED (2 WINDINGS) {2/8, 4/6 & 6/8 POLES}
Low Speed High Speed

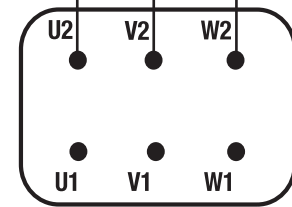
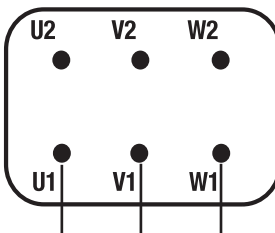

MS Type - Compact Brake Motor *D.C. Brake Coil*

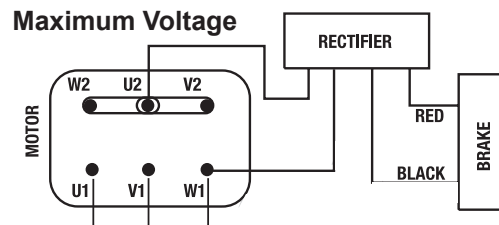
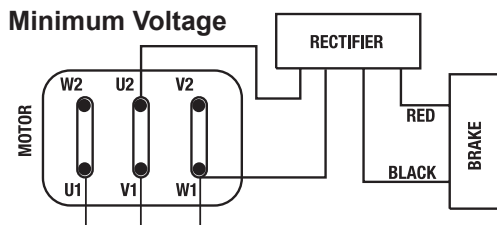

MS brake coils may also be wired separately by removing the leads from the motor block and connecting to an alternate/separate power source. Alternate voltage coils are available. Always check to ensure incoming voltage matches the coil voltage.

